

LIONSHEAD LOADING & DELIVERY

vailgov.com/loadinganddelivery

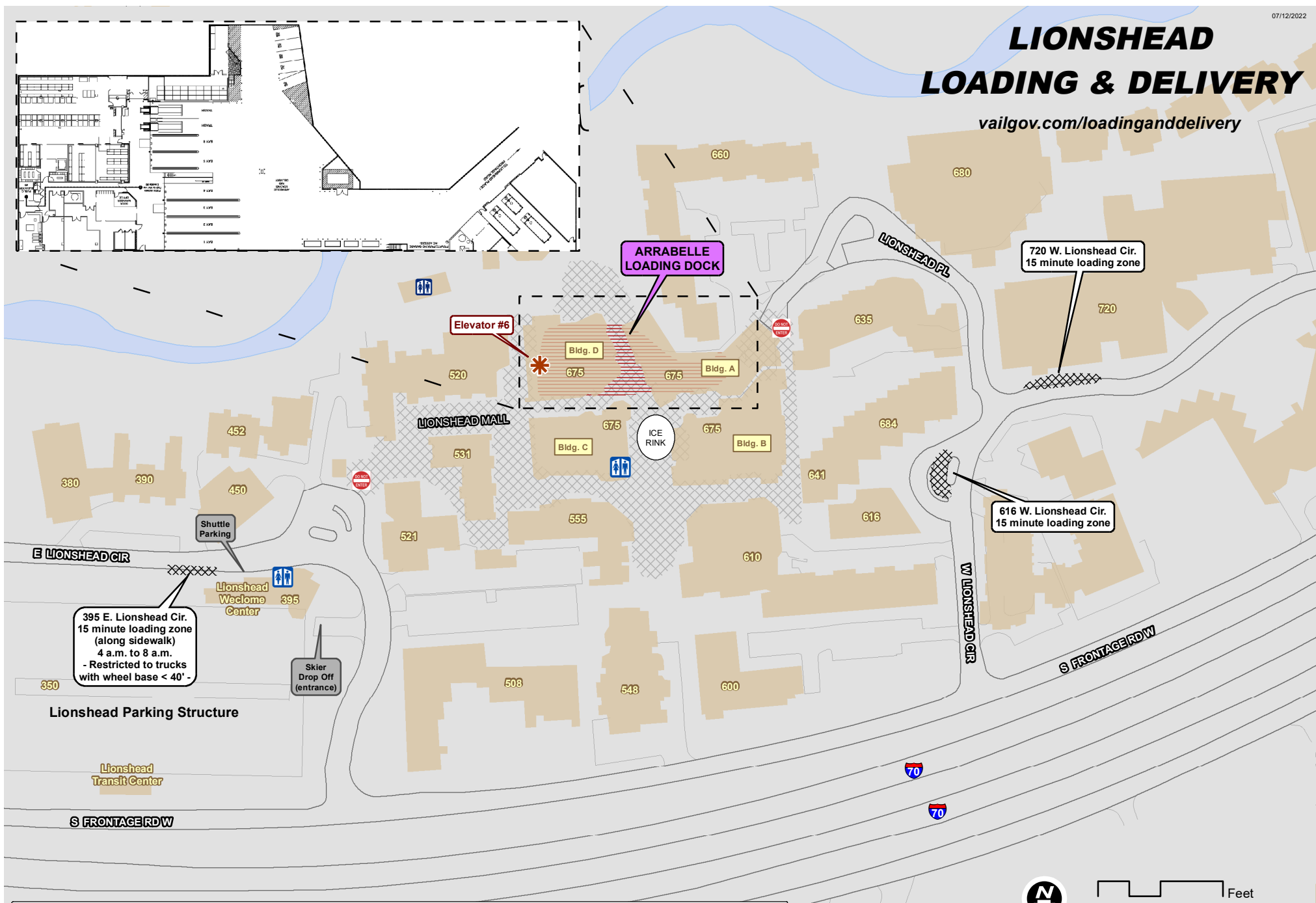
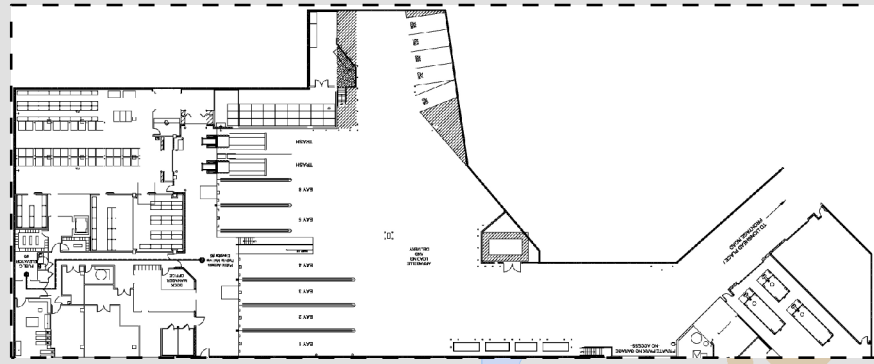

E-Vail Courier Service Coverage identified by heated pavers and its boundaries are generally contained within:
E. Meadow Dr. (Vail Rd. to Vail Valley Dr.); Willow Bridge Rd. (E. Meadow Dr. to Vail Rd.); Gore Creek Dr.
(Checkpoint Charlie to east end of Gorsuch / Clock Tower); and, Bridge St. (Slifer Square through Seibert Circle to Hanson Ranch Rd.)

Do Not Enter: Restricted to emergency services and Town of Vail vehicles, with some exceptions as indicated.



0 100 200 Feet